

FIXATION MOTEUR/PLATINE	
BS	VH835ZN (2X) VH860ZN (1X) HF8ZN (3X) NM8ZN (2X) VH840ZN (4X) NM8ZN (4X) HF8ZN (4X) JZ10ZN (4X)
HONDA	VH840ZN (4X) NM8ZN (4X) HF8ZN (4X) JZ10ZN (4X)
KAWA FC180V	VH1020ZN (4X) JZ10ZN (4X)

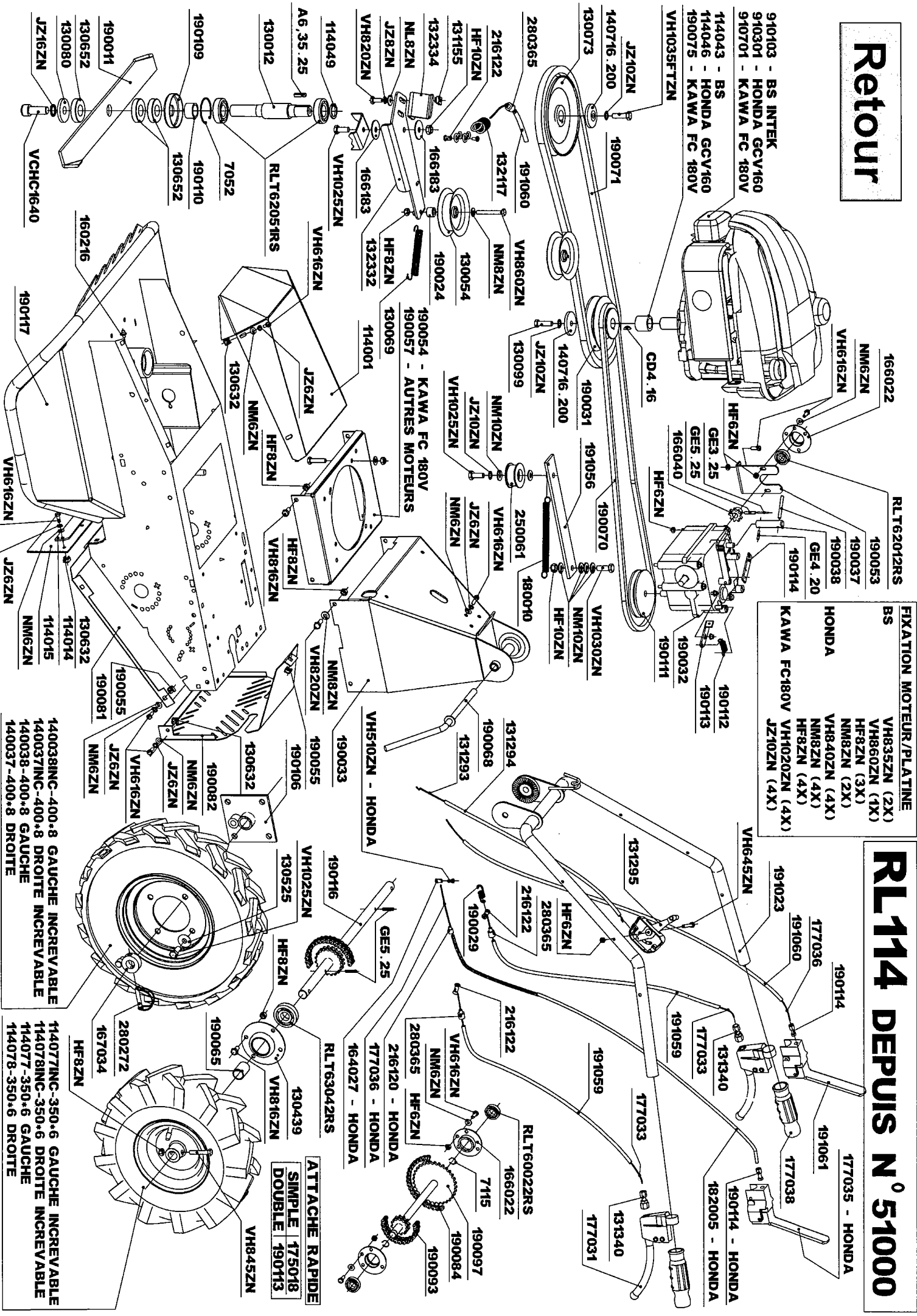

Retour

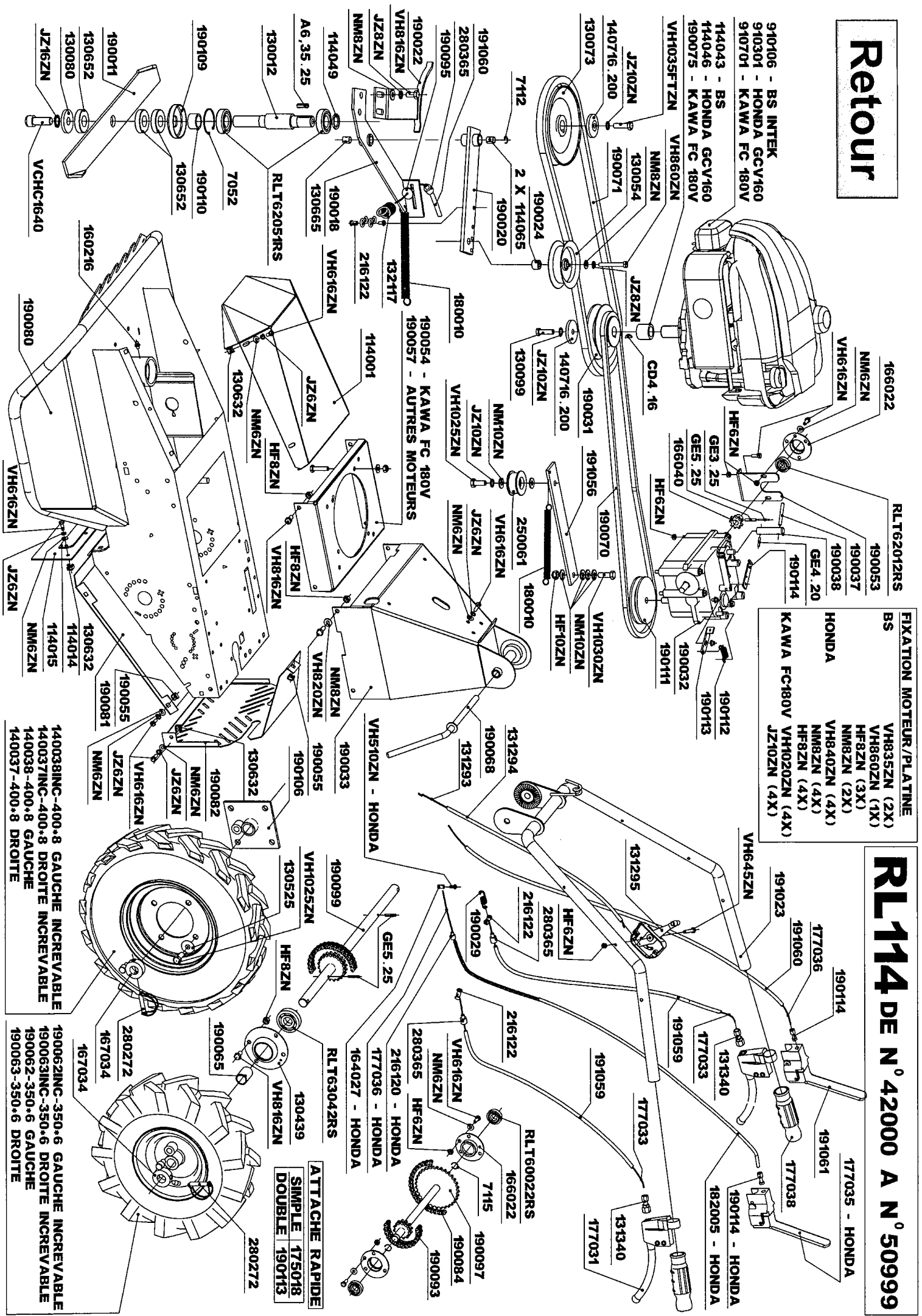

910106 - BS INTEK
 910301 - HONDA GCV160
 910701 - KAWA FC 180V

114043 - BS
 114046 - HONDA GCV160
 190075 - KAWA FC 180V

VH1035FTZN
 VH860ZLN

JZ10ZLN
 140716.200
 130073

190024
 2 X 114065
 190020

191060
 280365
 190095

190022
 VH816ZLN
 JZ8ZLN
 NM8ZLN

114049
 A6.35.25
 130012

190109
 130652
 190110
 130080
 JZ16ZLN
 VCHC1640

7052
 190110
 130652

190071
 130652
 130080
 JZ16ZLN

190001
 130652
 130080
 JZ16ZLN

166022
 NM6ZLN
 VH616ZLN

RLT62012RS
 190053
 190037
 190038
 GE4.20
 190114

HF6ZLN
 GE3.25
 GE5.25
 166040
 HF6ZLN

CD4.16
 190031
 191056
 190070
 190111

140716.200
 130099
 JZ10ZLN
 NM10ZLN
 VH616ZLN
 NM6ZLN

180010
 180010
 250061
 VH616ZLN
 NM6ZLN

132117
 216122
 114001
 JZ6ZLN
 HF8ZLN
 VH816ZLN

190054 - KAWA FC 180V
 190057 - AUTRES MOTEURS

130632
 NM6ZLN
 HF8ZLN
 VH816ZLN

130632
 NM6ZLN
 HF8ZLN
 VH816ZLN

130632
 NM6ZLN
 HF8ZLN
 VH816ZLN

130632
 NM6ZLN
 HF8ZLN
 VH816ZLN

130632
 NM6ZLN
 HF8ZLN
 VH816ZLN

FIXATION MOTEUR/PLATINE
 BS
 VH835ZLN (2X)
 VH860ZLN (1X)
 HF8ZLN (3X)
 NM8ZLN (2X)
 VH840ZLN (4X)
 NM8ZLN (4X)
 HF8ZLN (4X)
 VH1020ZLN (4X)
 JZ10ZLN (4X)

RL114 DE N° 42000 A N° 50999

190114
 177036
 191060
 191023

VH645ZLN
 131295
 HF6ZLN
 280365
 216122
 190029

191059
 177033
 131340
 177033

191059
 177033
 131340
 177031

RLT60022RS
 166022
 7115
 190097
 190084
 190093

VH616ZLN
 NM6ZLN
 280365
 HF6ZLN

216120 - HONDA
 216120 - HONDA
 177036 - HONDA
 164027 - HONDA

190099
 VH1025ZLN
 130525
 HF8ZLN

RLT63042RS
 130439
 VH816ZLN

190065
 280272
 167034
 167034

190065
 280272
 167034
 167034

140038INC-400.8 GAUCHE INCREVABLE
 140037INC-400.8 DROITE INCREVABLE
 140037-400.8 DROITE

ATTACHE RAPIDE
 SIMPLE 175018
 DOUBLE 190113